

THIS DOCUMENT AND THE DATA DISCLOSED
HEREIN OR HEREWITH IS NOT TO BE REPRODUCED,
USED, OR DISCLOSED IN WHOLE OR IN PART
TO ANYONE WITHOUT PERMISSION OF VICOR CORP.

REV.	DESCRIPTION	DATE	APPROVED
#1	RELEASED FOR DEVELOPMENT	DPK 2/18/97	SWN
#2	M3X.5 WAS #4-40	DPK 3/3/97	SWN
#3	REVISED DRAWING	JMR 3/6/97	SWN
#4	#4-40 TAP WAS M3X.5	DPK 4/28/97	SWN
#5	REVISED PROFILE AND NO OF FINS.	DPK 11/19/97	SWN
#6	ADDED ±.010 TOL TO DIM	DPK 12/8/97	SWN
#7	.49 WAS .490: REMOVED P/N STAMPING	DPK 8/24/98	SWN
#8	1.47 WAS 1.470	DPK 9/2/98	SWN
#9	.40 WAS .400: ADDED '0' TO .100 & .190	DPK 9/10/98	SWN
#A	ADDED NOTE 4, CRITICAL CHA. 'O'	AK 10/6/99	SWN

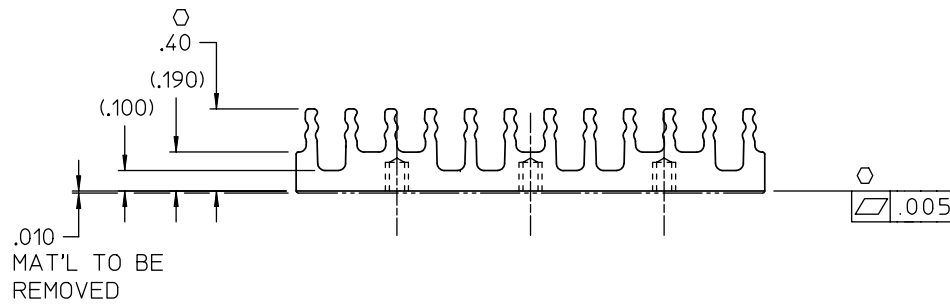
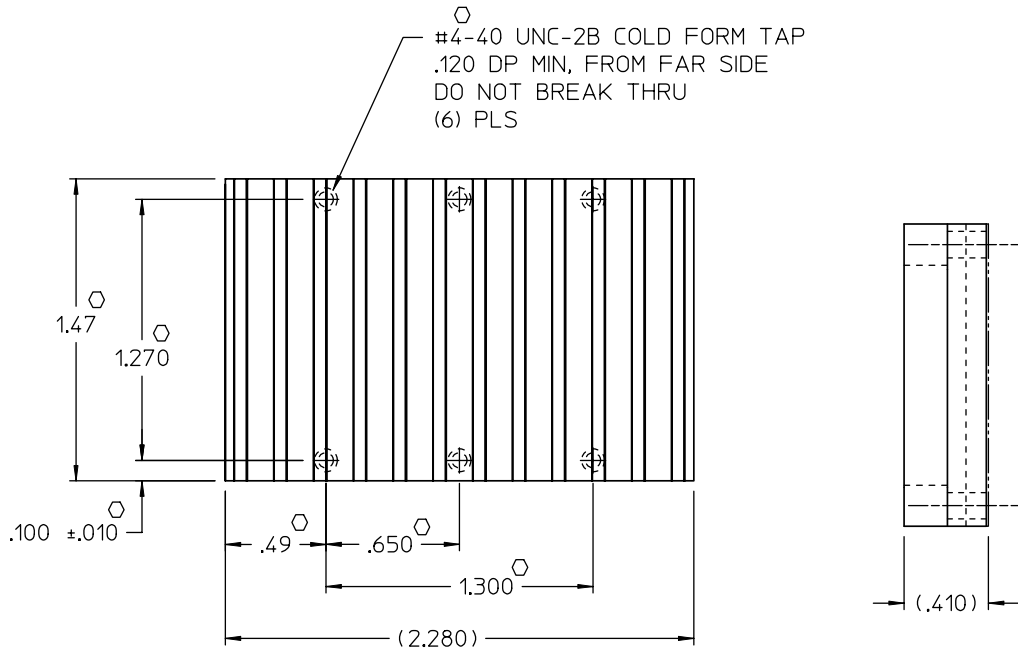

NOTES

1. MAKE FROM VICOR EXTRUSION P/N 16296.
2. REMOVE ALL BURRS AND SHARP EDGES.
3. FINISH. CLEAR CHROMATE.
4. "O" DENOTES CRITICAL CHARACTERISTICS FOR LOT INSPECTION.

DRAWN BY D.P. KELLY	DATE 2/97			
<small>UNLESS OTHERWISE SPECIFIED DIMENSIONS ARE IN INCHES- TOLERANCES ARE: FRACTIONS DECIMALS ANGLES +1/64 .XX ±.01 °1° .XXX ±.005</small>				
<small>THIRD ANGLE PROJECTION</small> 		SIZE C 67131	FSCM NO. DWG NO 16299	REV #A
<small>DO NOT SCALE DRAWING</small>		SCALE 2=1	SHEET 1 OF 1	